

6322 M/C3VL0241



INSOCOAT® deep groove ball bearing

INSOCOAT single row deep groove ball bearings feature an electrically insulating coating on the outside surfaces of either the inner or outer bearing ring. This keeps stray electric currents from passing through the bearings, protecting them against electrical erosion damage and helping prevent lubricant degradation resulting from electric current discharge. As with deep groove ball bearings generally, they are particularly versatile, have low friction and are optimized for low noise and low vibration, which enables high rotational speeds. They accommodate radial and axial loads in both directions, are easy to mount, and require less maintenance than many other bearing types.

- Coating protects against electrical erosion damage
- Reduced lubricant degradation resulting from electric current discharge
- Typical benefits of single row deep groove ball bearings

Overview

Dimensions

Bore diameter	110 mm
Outside diameter	240 mm
Width	50 mm

Performance

Basic dynamic load rating	216 kN
Basic static load rating	180 kN
Reference speed	6 000 r/min
Limiting speed	5 300 r/min

Properties

Filling slots	Without
Number of rows	1
Locating feature, bearing outer ring	None
Bore type	Cylindrical
Cage	Machined metal
Matched arrangement	No
Radial internal clearance	C3
Tolerance class	Normal
Material, bearing	Bearing steel
Coating	Insulation coating on outer ring
Sealing	Without
Lubricant	None

Relubrication feature

Without

Technical Specification



Dimensions

d	110 mm	Bore diameter
D	240 mm	Outside diameter
B	50 mm	Width
d_1	≈ 149.5 mm	Shoulder diameter inner ring
D_2	≈ 207 mm	Recess diameter outer ring shoulder
$r_{1,2}$	min. 3 mm	Chamfer dimension

Abutment dimensions

d_a	min. 124 mm	Abutment diameter shaft
D_a	min. 213 mm	Abutment diameter shaft
D_a	max. 226 mm	Abutment diameter housing
r_a	max. 2.5 mm	Fillet radius

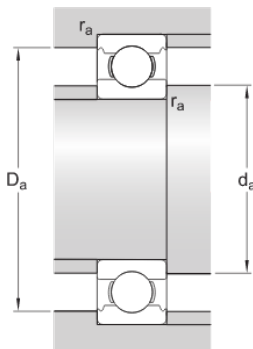

Calculation data

Basic dynamic load rating	C	216 kN
Basic static load rating	C_0	180 kN
Fatigue load limit	P_u	5.7 kN
Reference speed		6 000 r/min
Limiting speed		5 300 r/min
Calculation factor	k_r	0.03
Calculation factor	f_0	13.1

Mass

Mass bearing

11 kg

Terms and conditions

By accessing and using this website / app owned and published by AB SKF (publ.) (556007-3495 · Gothenburg) ("SKF"), you agree to the following terms and conditions:

Warranty Disclaimer and Limitation of Liability

Although every care has been taken to assure the accuracy of the information on this website / app, SKF provides this information "AS IS" and DISCLAIMS ALL WARRANTIES, EXPRESS OR IMPLIED, INCLUDING, BUT NOT LIMITED TO, IMPLIED WARRANTIES OF MERCHANTABILITY AND FITNESS FOR A PARTICULAR PURPOSE. You acknowledge that your use of this website / app is at your sole risk, that you assume full responsibility for all costs associated with use of this website / app, and that SKF shall not be liable for any direct, incidental, consequential, or indirect damages of any kind arising out of your access to, or use of the information or software made available on this website / app. Any warranties and representations in this website / app for SKF products or services that you purchase or use will be subject to the agreed upon terms and conditions in the contract for such product or service. Further, for non-SKF websites / apps that are referenced in our website / app or where a hyperlink appears, SKF makes no warranties concerning the accuracy or reliability of the information in these websites / apps and assumes no responsibility for material created or published by third parties contained therein. In addition, SKF does not warrant that this website / app or these other linked websites / apps are free from viruses or other harmful elements.

Third Party Services

When viewing YouTube content via the SKF website(s) (i.e. using YouTube API Services), you agree to be bound by the YouTube Terms of Service.

Copyright

Copyright in this website / app copyright of the information and software made available on this website / app rest with SKF or its licensors. All rights are reserved. All licensed material will reference the licensor that has granted SKF the right to use the material. The information and software made available on this website / app may not be reproduced, duplicated, copied, transferred, distributed, stored, modified, downloaded or otherwise exploited for any commercial use without the prior written approval of SKF. However, it may be reproduced, stored and downloaded for use by individuals without prior written approval of SKF. Under no circumstances may this information or software be supplied to third parties.

This website /app includes certain images used under license from Shutterstock, Inc.

Trademarks and Patents

All trademarks, brand names, and corporate logos displayed on the website / app are the property of SKF or its licensors, and may not be used in any way without prior written approval by SKF. All licensed trademarks published on this website / app reference the licensor that has granted SKF the right to use the trademark. Access to this website / app does not grant to the user any license under any patents owned by or licensed to SKF.

Changes

SKF reserves the right to make changes or additions to this website / app at any time.