

DRAWING CHANGE

| | | | | | | | | | | | | | | | | | | | | | | | |
|----|------|----------|------|----|--|----|--|----|--|----|--|----|--|----|--|----|--|----|--|----|--|----|--|
| 1 | 4487 | 2 | 4726 | 3 | | 4 | | 5 | | 6 | | 7 | | 8 | | 9 | | 10 | | 11 | | 12 | |
| 13 | | 14 | | 15 | | 16 | | 17 | | 18 | | 19 | | 20 | | 21 | | 22 | | 23 | | 24 | |

INC REV. DRAWINGS AT REVISION #.# ARE VALID FOR USE WITH DOCUMENTATION FOR REVISION #

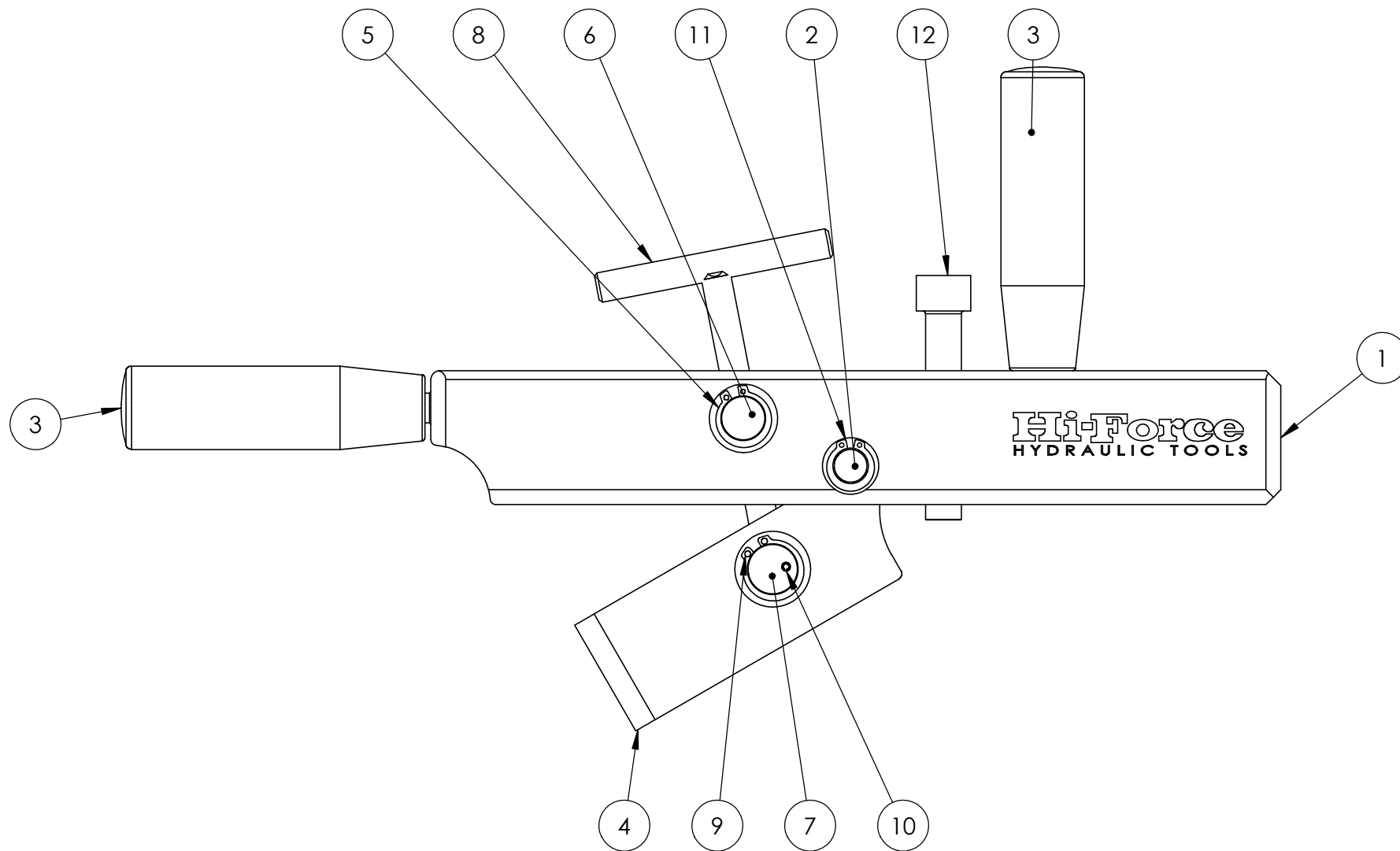

Hi-Force
HYDRAULIC TOOLS

PROSPECT WAY, DAVENTRY
NORTHANTS. NN11 8PL

TITLE:
BACK UP WRENCH HOLDER

THIS DRAWING IS THE SOLE PROPERTY OF HI-FORCE LTD.
AND MUST NOT BE LOANED, COPIED OR
USED IN ANY WAY WITHOUT THE WRITTEN CONSENT OF THE Co.

| | |
|-------|------------|
| DRAWN | MJD |
| DATE | 21/05/2015 |
| CHKD | |

| | |
|-----------|--|
| MATERIAL: | |
| FINISH: | |

REMARKS

UNLESS SPECIFIED
OTHERWISE, M/C FINISH
Ra 1.6 µm

DO NOT SCALE

ALL DIMS ARE IN mm AND INCLUDE ANY
SURFACE TREATMENTS.
TOLERANCES (UNLESS SPECIFIED OTHERWISE):
LINEAR DIMS ±0.25
ANGULAR DIMS ±0.5°
COAXIAL DIAMS TO BE CONCENTRIC TO WITHIN
0.05 T.I.R. REMOVE ALL BURRS AND SHARP EDGES

COMPONENT DRG NO.

BWH

SHT 1 OF 2 SHTS



DRAWING CHANGE

| | | | | | | | | | | | | | | | | | | | | | | | |
|----|------|----|------|----|--|----|--|----|--|----|--|----|--|----|--|----|--|----|--|----|--|----|--|
| 1 | 4487 | 2 | 4726 | 3 | | 4 | | 5 | | 6 | | 7 | | 8 | | 9 | | 10 | | 11 | | 12 | |
| 13 | | 14 | | 15 | | 16 | | 17 | | 18 | | 19 | | 20 | | 21 | | 22 | | 23 | | 24 | |

INC REV. DRAWINGS AT REVISION #.# ARE VALID FOR USE WITH DOCUMENTATION FOR REVISION #

| ITEM NO. | PART NUMBER | DESCRIPTION | QTY. |
|----------|-------------|---------------------|------|
| 1 | BUC045BL001 | BACKUP WRENCH BODY | 1 |
| 2 | SFC010RA001 | PIVOT PIN | 1 |
| 3 | HLC012PM001 | HANDLE | 2 |
| 4 | BUC015CF001 | REACTION PLATE | 1 |
| 5 | STC015AA001 | ROUGH MODEL | 1 |
| 6 | SFC014RA001 | PIVOT PIN | 1 |
| 7 | SFC017RA001 | LOWER PIVOT PIN | 1 |
| 8 | BUC010AF001 | ADJUSTMENT KNOB | 1 |
| 9 | STC017AA001 | ROUGH MODEL | 1 |
| 10 | PCC003RC004 | SPRING PIN | 1 |
| 11 | STC012AA001 | CIRCLIP | 1 |
| 12 | BLC012MC070 | SOCKET CAP HD SCREW | 1 |

Hi-Force
HYDRAULIC TOOLS
PROSPECT WAY, DAVENTRY
NORTHANTS. NN11 8PL

TITLE:
BACK UP WRENCH HOLDER

THIS DRAWING IS THE SOLE PROPERTY OF HI-FORCE LTD.
AND MUST NOT BE LOANED, COPIED OR
USED IN ANY WAY WITHOUT THE WRITTEN CONSENT OF THE Co.

DRAWN
MJD
DATE
21/05/2015
CHKD

MATERIAL:

FINISH:

REMARKS

UNLESS SPECIFIED
OTHERWISE, M/C FINISH
Ra 1.6 µm

DO NOT SCALE
ALL DIMS ARE IN mm AND INCLUDE ANY
SURFACE TREATMENTS.
TOLERANCES (UNLESS SPECIFIED OTHERWISE):
LINEAR DIMS ±0.25
ANGULAR DIMS ±0.5°
COAXIAL DIAMS TO BE CONCENTRIC TO WITHIN
0.05 T.I.R. REMOVE ALL BURRS AND SHARP EDGES

COMPONENT DRG NO.
BWH
SHT 2 OF 2 SHTS